

VYTYČOVACÍ VÝKRES 1

OPRAVA CHODNÍKŮ A VJEZDŮ V OBCI BŘVANY

M 1:200

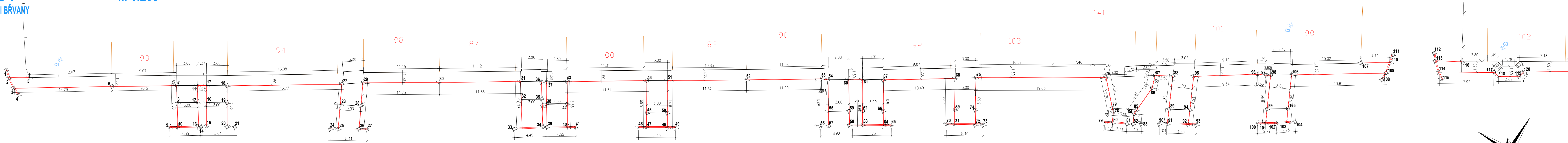

SEZNAM VYTYČOVACÍCH BODŮ:

1	X=1001117.9875	Y=786862.1780	31	X=1001051.9499	Y=786898.5749	61	X=1001008.7857	Y=786923.9887	91	X=1000966.8499	Y=786940.7809	121	X=1000929.2801	Y=786971.3498	151	X=1000867.5565	Y=787000.6343	181	X=1000793.5175	Y=787047.1305
2	X=1001117.1327	Y=786861.3357	32	X=1001050.5540	Y=786896.3365	62	X=1001006.4180	Y=786919.9883	92	X=1000964.2004	Y=786942.2091	122	X=1000928.3536	Y=786971.1506	152	X=1000870.7987	Y=787005.9492	182	X=1000793.0537	Y=787047.3527
3	X=1001115.7715	Y=786860.4056	33	X=1001049.3058	Y=786892.0673	63	X=1001005.3994	Y=786918.2672	93	X=1000963.1406	Y=786942.7804	123	X=1000925.7851	Y=786972.6614	153	X=1000867.9039	Y=787007.6499	183	X=1000793.3984	Y=787045.5245
4	X=1001114.6762	Y=786859.9153	34	X=1001045.8183	Y=786894.4121	64	X=1001002.7441	Y=786919.6714	94	X=1000965.0660	Y=786944.1850	124	X=1000925.5478	Y=786973.5710	154	X=1000863.9833	Y=787002.6356	184	X=1000792.4058	Y=787045.9998
5	X=1001114.5100	Y=786862.9200	35	X=1001047.9691	Y=786897.8610	65	X=1001001.7178	Y=786920.2934	95	X=1000967.0640	Y=786948.7457	125	X=1000919.7048	Y=786977.0518	155	X=1000861.3687	Y=787004.1620	185	X=1000792.0223	Y=787042.4206
6	X=1001103.4068	Y=786867.8746	36	X=1001049.3261	Y=786900.0369	66	X=1001003.8334	Y=786921.5152	96	X=1000959.0935	Y=786953.7064	126	X=1000917.4382	Y=786974.3521	156	X=1000860.3256	Y=787004.7762	186	X=1000790.9509	Y=787042.9618
7	X=1001095.2554	Y=786872.7508	37	X=1001048.6755	Y=786900.4242	67	X=1001006.1570	Y=786925.4485	97	X=1000957.9260	Y=786954.2191	127	X=1000916.4202	Y=786971.3012	157	X=1000865.3204	Y=787009.2162	187	X=1000787.3350	Y=787044.8209
8	X=1001093.9484	Y=786870.6189	38	X=1001046.9700	Y=786897.5874	68	X=1000997.1044	Y=786930.5388	98	X=1000957.3460	Y=786954.5624	128	X=1000915.5821	Y=786971.9031	158	X=1000865.6557	Y=787015.0753	188	X=1000786.2622	Y=787045.3591
9	X=1001093.0753	Y=786866.8987	39	X=1001045.2644	Y=786894.7507	69	X=1000994.8478	Y=786926.9253	99	X=1000955.3016	Y=786950.0146	129	X=1000912.0900	Y=786973.7758	159	X=1000847.2798	Y=787020.0931	189	X=1000788.7402	Y=787047.7552
10	X=1001092.0395	Y=786867.5051	40	X=1001042.6160	Y=786896.1679	70	X=1000994.8100	Y=786924.4800	100	X=1000955.4486	Y=786947.4148	130	X=1000911.0557	Y=786974.3860	160	X=1000846.0536	Y=787013.1808	190	X=1000789.3681	Y=787049.1081
11	X=1001092.6624	Y=786874.2611	41	X=1001041.5823	Y=786896.7733	71	X=1000993.7941	Y=786925.0512	101	X=1000954.4137	Y=786948.0094	131	X=1000914.1665	Y=786976.2491	161	X=1000845.0016	Y=787013.8001	191	X=1000789.3200	Y=787050.0100
12	X=1001091.3554	Y=786872.1292	42	X=1001044.3989	Y=786899.1332	72	X=1000991.1736	Y=786926.5216	102	X=1000953.1264	Y=786948.8200	132	X=1000916.4736	Y=786978.9970	162	X=1000840.7758	Y=787016.2845	192	X=1000783.3913	Y=787061.5577
13	X=1001089.5494	Y=786869.1833	43	X=1001046.1071	Y=786901.9744	73	X=1000990.1331	Y=786927.1096	103	X=1000951.8643	Y=786949.6852	133	X=1000898.4829	Y=786989.6424	163	X=1000843.0254	Y=787022.4785	193	X=1000783.2182	Y=787059.9774
14	X=1001089.1700	Y=786869.2400	44	X=1001036.0194	Y=786907.9812	74	X=1000992.2328	Y=786928.3955	104	X=1000950.8617	Y=786950.3815	134	X=1000897.8400	Y=786986.9000	164	X=1000842.1789	Y=787022.9614	194	X=1000780.7650	Y=787058.1752
15	X=1001088.5197	Y=786869.7960	45	X=1001033.6656	Y=786903.8761	75	X=1000992.5539	Y=786932.5237	105	X=1000952.7143	Y=786951.5759	135	X=1000897.9410	Y=786982.3104	165	X=1000837.8811	Y=787017.9368	195	X=1000759.9929	Y=787059.2277
16	X=1001090.2523	Y=786872.7725	46	X=1001033.6336	Y=786901.4078	76	X=1000997.0516	Y=786942.1710	106	X=1000954.7538	Y=786956.1129	136	X=1000896.9139	Y=786982.9310	166	X=1000835.2431	Y=787019.4681	196	X=1000759.5315	Y=787060.6604
17	X=1001091.5096	Y=786874.9325	47	X=1001032.5962	Y=786902.0110	77	X=1000994.9755	Y=786938.7308	107	X=1000946.8100	Y=786962.6900	137	X=1000893.5653	Y=786984.9526	167	X=1000834.2065	Y=787020.0727	197	X=1000759.5414	Y=787061.9461
18	X=1001088.8964	Y=786876.4065	48	X=1001029.9937	Y=786903.5032	78	X=1000997.5536	Y=786938.2590	108	X=1000942.8886	Y=786962.0984	138	X=1000894.4707	Y=786988.8332	168	X=1000839.5928	Y=787024.5532			
19	X=1001087.6386	Y=786874.2457	49	X=1001028.9534	Y=786904.1014	79	X=1000994.9481	Y=786936.3168	109	X=1000942.9178	Y=786963.2980	139	X=1000895.1136	Y=786991.5755	169	X=1000828.7567	Y=787031.0823			
20	X=1001085.8531	Y=786871.1783	50	X=1001031.0631	Y=786905.3684	80	X=1000993.8830	Y=786936.8708	110	X=1000943.1087	Y=786964.9369	140	X=1000893.3679	Y=786992.5985	170	X=1000825.2228	Y=787027.8964			
21	X=1001084.8063	Y=786871.7652	51	X=1001033.4288	Y=786909.4944	81	X=1000990.6300	Y=786937.7900	111	X=1000943.3561	Y=786966.1111	141	X=1000890.8300	Y=786996.7200	171	X=1000825.2188	Y=787025.3092			
22	X=1001074.4267	Y=786885.0849	52	X=1001023.4727	Y=786915.3911	82	X=1000997.2121	Y=786938.2387	112	X=1000938.2647	Y=786969.3964	142	X=1000890.3056	Y=786996.9159	172	X=1000824.1709	Y=787025.8946			
23	X=1001073.1213	Y=786882.3628	53	X=1001014.0341	Y=786938.8460	83	X=1000997.5306	Y=786938.4472	113	X=1000937.3144	Y=786968.4472	143	X=1000887.3144	Y=786998.7222	173	X=1000821.5511	Y=787027.3583			
24	X=1001072.6275	Y=786878.5584	54	X=1001013.1407	Y=786921.4520	84	X=1000997.8522	Y=786939.5638	114	X=1000936.3514	Y=786967.3024	144	X=1000886.2864	Y=786989.3441	174	X=1000820.5031	Y=787027.9438			
25	X=1001071.5775	Y=786879.1441	55	X=1001010.7326	Y=786917.4200	85	X=1000990.5810	Y=786940.2690	115	X=1000942.9178	Y=786963.2980	145	X=1000890.3676	Y=786994.3879	175	X=1000825.5672	Y=787029.2919			
26	X=1001068.9527	Y=786880.6086	56	X=1001010.6609	Y=786914.9598	86	X=1000997.4491	Y=786944.2084	116	X=1000934.1200	Y=786970.3000	146	X=1000881.6061	Y=786999.6830	176	X=1000822.9535	Y=787034.3680			
27	X=1001067.9047	Y=786881.1983	57	X=1000992.0168	Y=786915.5741	87	X=1000997.2018	Y=786945.9711	117	X=1000929.5306	Y=786971.3498	147	X=1000876.2308	Y=787002.6858	177	X=1000810.8721	Y=787041.7455			
28	X=1001070.4163	Y=786883.6602	58	X=1001007.1314	Y=786917.2412	88	X=1000969.6831	Y=786947.2478	118	X=1000928.3536	Y=786971.1506	148	X=1000873.4388	Y=787004.3794	178	X=1000800.6934	Y=787049.3386			
29	X=1001071.9044	Y=786886.7631	59	X=1000982.7156	Y=786942.7568	89	X=1000925.7156	Y=786942.7568	119	X=1000925.7156	Y=786942.7568	149	X=1000871.2315	Y=786998.4567	179	X=1000800.4742	Y=787047.7018			
30	X=1001062.1860	Y=786892.4891	60	X=1001010.5383	Y=786922.9454	90	X=1000967.8954	Y=786940.7809	120	X=1000925.5478	Y=786973.5710	150	X=1000870.2035	Y=786999.0757	180	X=1000793.5600	Y=787048.4100			

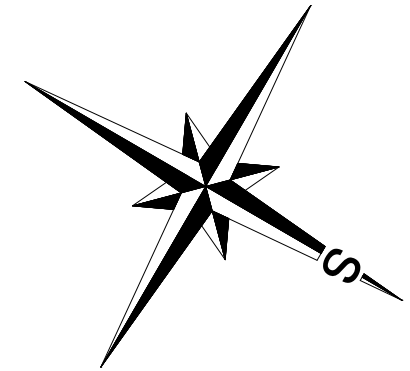

Aleš Dvořák, Ostrov 2212, 438 01 Žatec, e- mail: ales.dvorak@projekty-zatec.cz, mobil: 774 492 007				
stupeň dokumentace:	PD K OPRAVĚ			
zodp. projektant:	ALEŠ DVOŘÁK	kreslil:	ALEŠ DVOŘÁK	
vypracoval:	ALEŠ DVOŘÁK	kontroloval:		
investor:	OBEC BŘVANY, DLOUHÁ 41, 439 23 BŘVANY			
název projektu:	OPRAVA CHODNÍKŮ A VJEZDŮ V OBCI BŘVANY			
předmět výkresu:	VYTYČOVACÍ VÝKRES 1		formát:	6 x A4
			datum:	01 - 2020
		měřítko	1 : 200	
		č.výkresu:	2	
		č.paré:		